

# CERTIFIED BOUNDARY SURVEY

Land situated in Springfield Township, Williams County, Ohio, being the West 107.00 feet of Lot 12, Plat of Tingley's Addition to the Village of Stryker, Town 6 North, Range 4 East

Mulberry Street (66' Wide)

West Street (66' Wide)

(Res'd #309)  
0.324 AC.

Lot 12

Lot 20

Lot 19

Bell survey calls iron 2.48' from true point. Iron set by W. Schelling Aug. 1988 Vol. 6V, Page 196

D. Bell survey Oct. 2004 Vol. 8V, Page 249

BASIS OF BEARINGS ARE REFERENCED TO THE PLAT OF TINGLEY'S ADDITION TO THE VILLAGE OF STRYKER

**LEGEND:**

- FOUND EXISTING PROPERTY CORNER AS NOTED
- SET 5/8" x 30" REBAR WITH RED CAP STAMPED 'OHIO PS 7261'
- (M) MEASURED DIMENSION (THIS SURVEY)
- (P) PLAT DIMENSION (PER RECORDED PLAT)
- (R) RECORD DIMENSION (PRIOR SURVEY)

This Survey is Recorded in Volume 10V, Page 38, of the Williams County Engineers Office

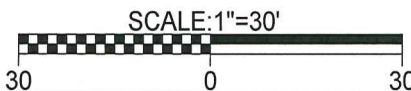

CLIENT: JOE GARCIA

JOB NO: 1806004

DATE: JUNE 7, 2018

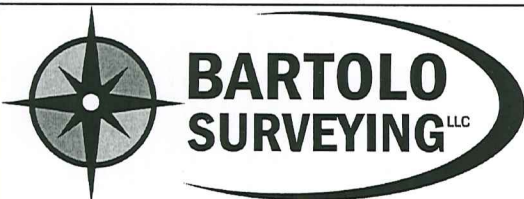

131 E. FRONT STREET  
ADRIAN, MICHIGAN 49221-2726  
PHONE: (517) 265-6887  
FAX: (517) 263-6021  
E-MAIL: BARTOLOSURVEYING@YAHOO.COM

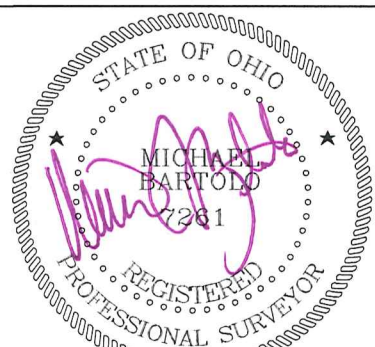

I hereby certify that I have surveyed the parcel of land above described and delineated hereon. If the signature on this survey is not violet colored, the survey is a copy that should be assumed to contain unauthorized alterations. The certification contained on this document shall not apply to any copies. This paper is an important document regarding your property. Please file it with other important documents such as deeds, title policies, etc. Please protect your property corners so future landowners and surveyors can find and identify your property boundary.

MICHAEL J. BARTOLO, P.S.  
(MICHIGAN # 33970 - OHIO # 7261)